

### SINGLE PHASE – DIGITAL PRESSURE SWITCH

## Oil-Less Riser Mount

Digital Fire Protection Air Compressors  
for Dry Pipe & Pre-Action Sprinkler Systems.

Our OL Advance Series Riser Mount Digital Air Compressors Feature an all-new, UL-508 Listed, General Air Products Digital Pressure Switch. Our digital pressure switch makes it easy to adjust and maintain pressure from low, standard or high pressure, while cutting down on setup time.

### PRE-SET PRESSURES FOR EASY INSTALLATION

Easily adjust to any custom setting with the push of a button.

**OL** Advance  
Series



Includes Riser Mounting Bracket,  
30" Stainless Steel Flex Hose  
& Union.



System Capacity (gal)*		Model Number	CFM @10 PSIG	Motor HP	Voltage (volts)	Amperage (amps)		Recommended Wire Size (gauge)			Unit Weight (lbs)
@18 PSI	@40 PSI					FLA	Start Up	25' Run	50' Run	100' Run	
320	120	OLRV120-A	1.46	1/6	115	3.8	27	12	12	12	29
					208-230	2.2	15	12	12	12	
695	250	OLRV250-A	3.03	1/3	115	4.3	30	12	12	10	33
					208-230	2.3	16	12	12	12	
1160	400	OLRV400-A	4.85	1/2	115	9.4	66	12	10	6	45
					208-230	4.9	34	12	12	12	
1270	500	OLRV500-A <sup>+</sup>	6.06 <sup>+</sup>	3/4	115	9.9	69	12	10	6	45
					208-230	5.1	36	12	12	12	
1575	600	OLRV600-A <sup>+</sup>	7.28 <sup>+</sup>	1	115	11.3	79	12	10	6	45
					208-230	5.7	40	12	12	12	
2850	915	OLRV915-A <sup>+</sup>	11.1 <sup>+</sup>	1 1/2	115	16.6	116	12	8	8	60
					208-230	8.4	58	10	8	6	
3380	1100	OLRV1095-A <sup>+</sup>	13.34 <sup>+</sup>	2	208	11.3	79	10	8	6	70
					230	9.6	79	12	12	10	

### Features and Benefits

- UL 1450-VDUR Listed
- CSA C22.2 No.68-Canada
- Oil-Less Piston Compressor
- UL Listed, Digital Pressure Switch
- Displays Pressure Readings
- Displays & Records Run Hours
- Displays Amperage
- Displays & Records Cycles
- Fully Automatic, Direct Drive
- ASME Pressure Safety Valve
- Bubble Tight Air Check Valve
- Pre-Wired & Pre-Tested
- Lifetime Technical Support
- Annual Automated Maintenance Reminders

\* System Capacity based on 30min fill-time at 70° F system temperature.

<sup>+</sup> Compressor has a capacity above 5.5 CFM @ 10 PSIG. A listed Air Maintenance Device is required on systems supervised by this compressor per NFPA 13.

Note: All information is subject to change without notice. Consult factory for most up-to-date product details.

⚠ WARNING: Cancer and Reproductive Harm – [www.p65warnings.ca.gov](http://www.p65warnings.ca.gov)

### System Capacity (gal) by System Pressure

Model Number	@20 PSI	@30 PSI	@40 PSI	@50 PSI	@60 PSI	@70 PSI	@80 PSI	@90 PSI	@100 PSI
OLRV120-A	265	170	120	95	75	65	55	45	40
OLRV250-A	565	350	250	190	155	125	105	90	75
OLRV400-A	930	595	400	325	255	215	180	155	135
OLRV500-A	1030	655	500	360	290	240	200	170	145
OLRV600-A	1250	790	600	435	350	285	240	210	180
OLRV915-A	2190	1325	910	680	525	420	340	280	240
OLRV1095-A	2630	1625	1140	860	690	555	465	390	340

The OL Advance Series Digital Fire Protection Air Compressors are UL 1450-VDUR Listed and specifically designed to fill dry pipe and pre-action fire sprinkler systems to supervisory pressure within 30 minutes per NFPA 13.

### OL Advance Series Riser Mount Digital Fire Protection Air Compressors

**MODEL: OLRV120-A**

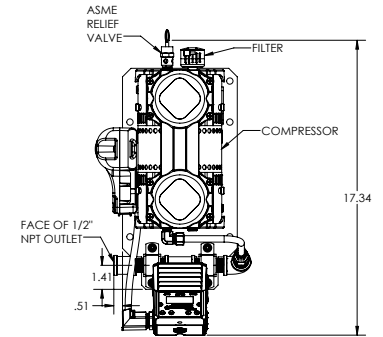
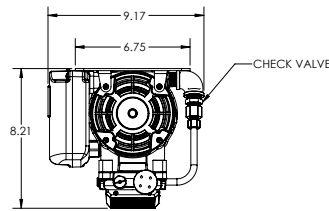

**MODEL: OLRV250-A**

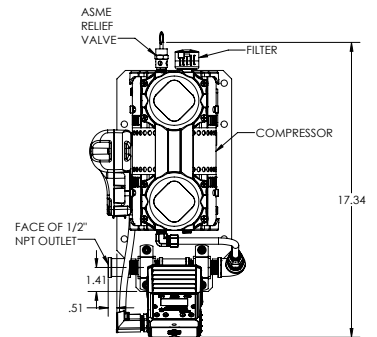
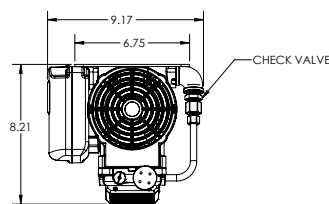

**MODEL: OLRV400-A | MODEL: OLRV500-A | MODEL: OLRV600-A**

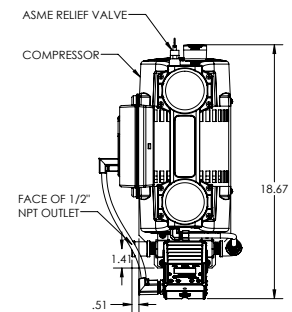
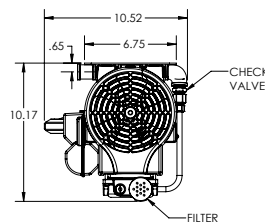

**MODEL: OLRV915-A | MODEL: OLRV1095-A**

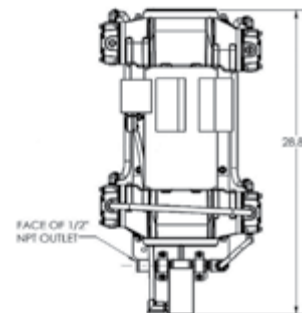
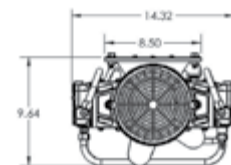

### OL Advance Series Riser Mount Digital Fire Protection Air Compressors Accessories

#### VAPOR PIPE SHIELD



Vapor Pipe Shield is a Patented and UL Listed innovative solution for the prevention of corrosion in Dry-Pipe & Pre-Action Fire Sprinkler Systems.

#### AIR MAINTENANCE DEVICE



Part # AMD-1

The AMD-1 regulates the volume of air being delivered to the sprinkler system by the air compressor.

*Per NFPA 13 - An Air Maintenance Device is required on every dry system unless the air compressor has a capacity less than 5.5 ft<sup>3</sup>/min at 10 PSI.*

#### MOTOR LINE STARTER



##### Thermal Overload Protection

MAX HP	SINGLE PHASE MOTOR LINE STARTERS			
	115V	208-230V	Size	Model
1/3 HP	1 HP	00		MG00A
1 HP	2 HP	0		MG00A
2 HP	3 HP	1		MG01A
3 HP	5 HP	1P		MG15A

*When Ordering a Motor Starter you must specify HP, Voltage & Phase.*