

UL LISTED SINGLE PHASE 80/100 PSI PRE-WIRED WITH OVERLOAD PROTECTION

Lubricated Tank Mounted Digital Fire Protection Air Compressors for Dry Pipe & Pre-Action Sprinkler Systems.

LT Advance Series



The LT Advance Series Tank Mounted Air Compressors Feature an all-new, UL 508 Listed, General Air Products Digital Pressure Switch. Our digital pressure switch makes it easy to adjust and maintain pressure from low, standard or high pressure, while cutting down on setup time. The Digital Pressure Switch also actuates an Automatic Drain Valve.

PRE-SET PRESSURES FOR EASY INSTALLATION

Easily adjust to any custom setting with the push of a button.

All tank mounted compressors require an Air Maintenance Device to regulate system pressure.



Includes Oil, Vibration Pads, 30" Stainless Steel Flex Hose & Union

System Capacity (gal)* @40 PSI	Model Number	CFM @ 10 PSIG	Motor HP	Voltage (volts)	Amperage (amps)			Recommended Wire Size (gauge)			Tank Size (gal)	Unit Weight (lbs)
					FLA	SFA	Start Up	25' Run	50' Run	100' Run		
200	LTV200-A	2.40	3/4	115	11	10	77	12	10	8	10	124
				208-230	5.5	5	35	12	10	8		
500	LTV500-A	6.21	1 1/2	115	13	14	98	12	10	6	20	181
				208-230	6.49	7	49	12	10	6		
1050	LTV1050-A2S	12.73	3	208	13.6	14	98	10	6	4	20	190
	LTV1050-A3S			230	12.1	14	98	12	12	10		
1400	LTV1400-A2S	16.97	3	208	13.7	14	98	10	6	4	30	310
	LTV1400-A3S			230	12.8	14	98	12	12	10		
2200	LTV2200-A2S	29.00	5	208	21.5	21.5	150	8	4	4	30	319
	LTV2200-A3S			230	19.7	21.5	150	12	10	8		

- ### Features and Benefits
- UL 1450, Supplement SC Listed
 - CSA C22.2 No.68-Canada
 - UL Listed, Digital Pressure Switch
 - Displays Pressure Readings
 - Displays & Records Run Hours
 - Displays Amperage
 - Displays & Records Cycles
 - ASME Pressure Safety Valve
 - Bubble Tight Air Check Valve
 - All Compressors Are Pre-Tested
 - Lifetime Technical Support
 - Automatic Tank Drain Valve
 - Annual Automated Maintenance Reminders

* System Capacity based on 30min fill and at 70°F system temperature.

Note: A listed Air Maintenance Device must be installed in conjunction with all Tank Mounted air compressors.

Note: All compressors are pre-wired with overload protection.

Note: All information is subject to change without notice. Consult factory for most up-to-date product details

WARNING: Cancer and Reproductive Harm – www.p65warnings.ca.gov

System Capacity (gal) by System Pressure									
Model Number	20 PSI	30 PSI	40 PSI	50 PSI	60 PSI	70 PSI	80 PSI	90 PSI	100 PSI
LTV200-A	550	300	200	190	160	130	110	90	80
LTV500-A	1250	750	500	430	350	300	250	210	180
LTV1050-A	2350	1550	1050	890	740	620	530	460	400
LTV1400-A	3150	2100	1400	1250	1050	900	770	680	470
LTV2200-A	4800	3050	2200	1390	1160	1190	1020	900	800

The LT Advance Series, Lubricated Tank Mounted Digital Fire Protection Air Compressors are specifically designed to fill dry pipe and pre-action fire sprinkler systems to supervisory pressure within 30 minutes per NFPA 13.

LT Advance Series Tank Mounted Digital Fire Protection Air Compressors

MODEL: LTV200-A

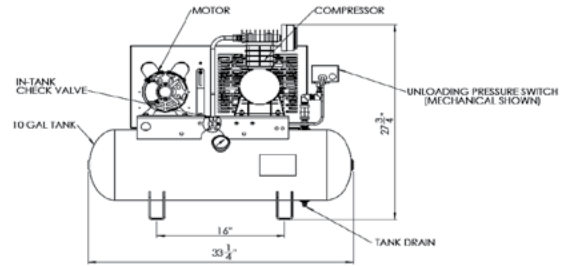
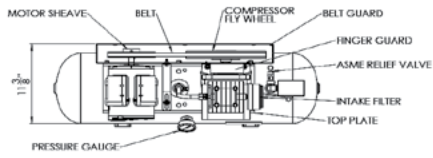

MODEL: LTV500-A

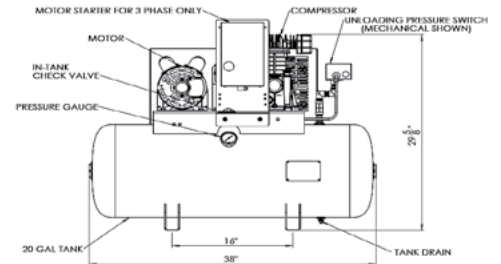
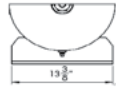
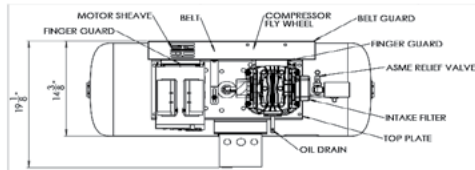

MODEL: LTV1050-A

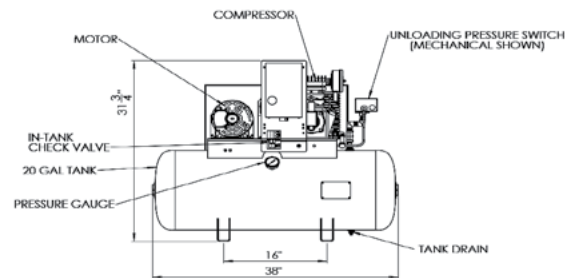
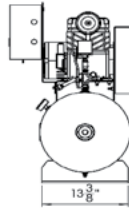
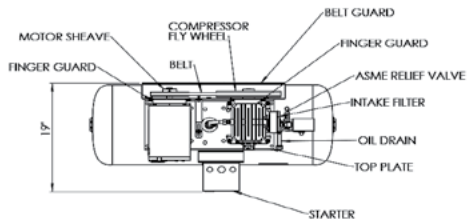

MODEL: LTV1400-A

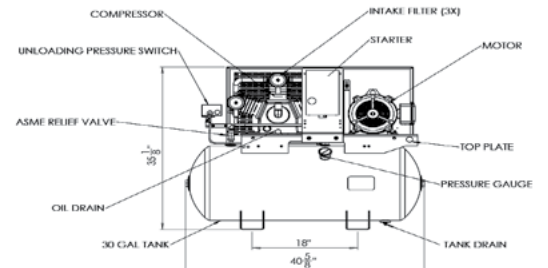
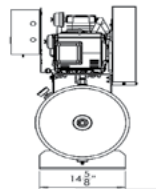
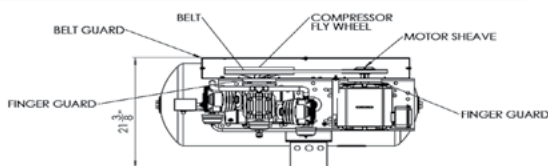

MODEL: LTV2200-A

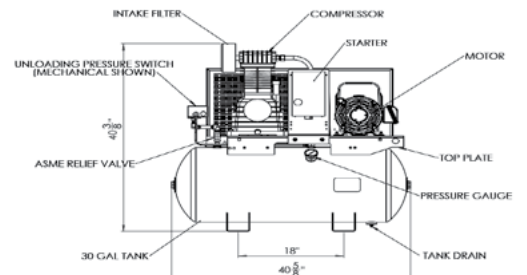
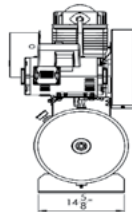
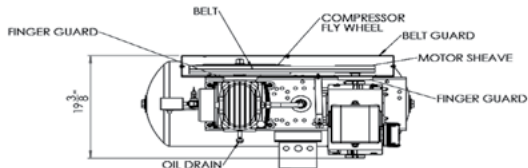

LT Advance Series Tank Mounted Digital Fire Protection Air Compressors Accessories

VAPOR PIPE SHIELD



Vapor Pipe Shield is a Patented and UL Listed innovative solution for the prevention of corrosion in Dry-Pipe & Pre-Action Fire Sprinkler Systems.

[LEARN MORE](#)

AIR MAINTENANCE DEVICE



Part # AMD-1

The AMD-1 regulates the volume of air being delivered to the sprinkler system by the air compressor.

Per NFPA 13 - An Air Maintenance Device is required on every dry system unless the air compressor has a capacity less than 5.5 ft³/min at 10 PSI.

[LEARN MORE](#)

ANNUAL MAINTENANCE REMINDERS



We Make Maintenance Easy!

You can now sign up for maintenance reminders for all of your General Air Products Equipment and we'll send you reminders when your maintenance dates are approaching. It really is that simple!

[LEARN MORE](#)